

Honeywell Adaptec™
Protective Eyewear system

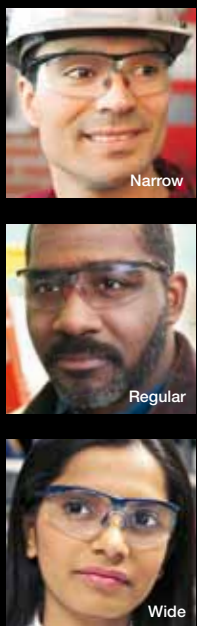

One style. Three sizes.
Customized fit & performance.

Instructions for a customized fit

Four easy steps to correctly adjust your glasses
for greater comfort and safety

1 Choose the correct spectacle size

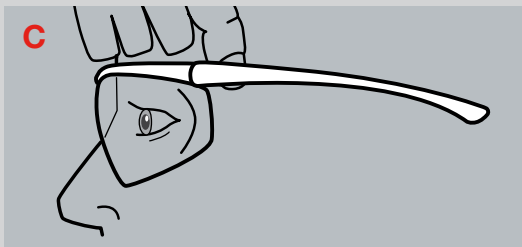
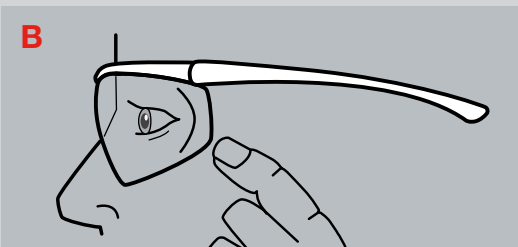
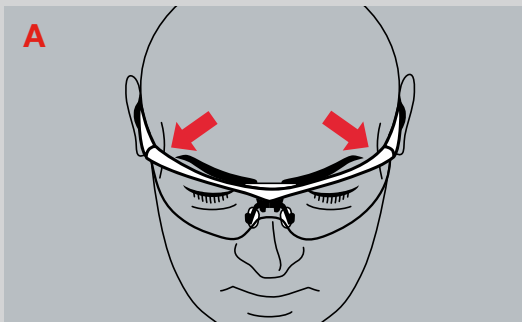

2 Adjust the height of the lens to center your eyes

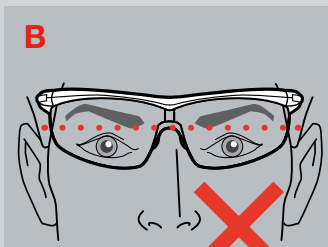
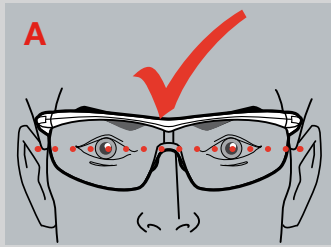
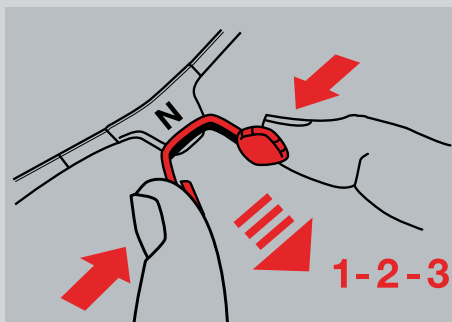

3 Choose inclination of temple hinge to adjust the pantoscopic angle

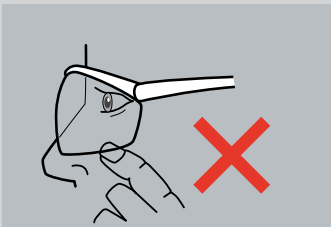
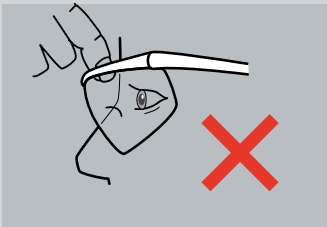
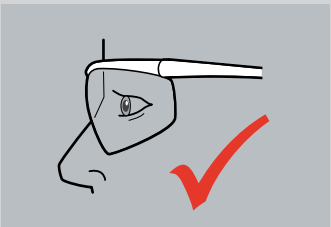
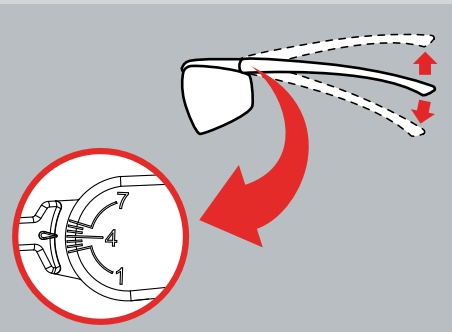

4 Adjust the pressure of the temples for the best fit

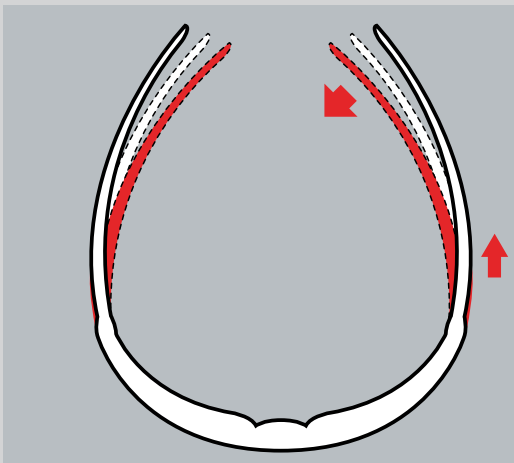
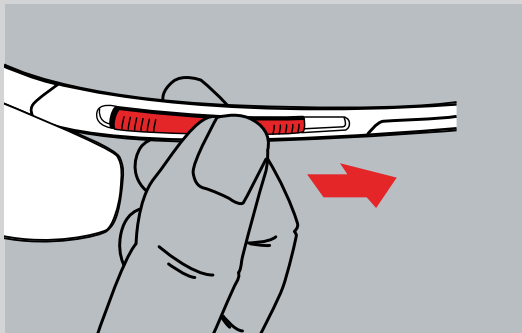

▲ WARNING: To be effective, safety glasses must be chosen and adjusted correctly. If the instructions contained in this user guide concerning the correct choice of lens size and the suitable adjustment of the glasses are not followed, then this may lead to inadequate protection, including a lack of side protection in compliance with the ANSI Z87.1-2010, CE EN166 and CSA Z94.3 protection standards for the eyes and face. Failure to heed these instructions may lead to serious injury and blindness.

DOC2519 - July 2011 - © 2011 Honeywell International Inc.

Lead them to safety — Build an enduring culture of safety where employees make safe choices on their own: <http://honeywellsafety.com>